

# BEST 45H SERIES ELECTRIC LOCK M1510/1520C

## FUNCTION CHANGE INSTRUCTIONS

TO CHANGE THE LOCKING FUNCTION FOLLOW THE BELOW INSTRUCTIONS CAREFULLY.

STEP 1: REMOVE THE 4 COVER SCREWS AND COVER

STEP 2: USING THE ILLUSTRATION BELOW, REMOVE SCREW AND REPLACE SCREW IN PROPER HOLE AS FOLLOWS

**A** FOR FAIL SAFE M1510C (POWER LOCK) FUNCTION

**B** FOR FAIL SECURE M1520C (POWER UNLOCK) FUNCTION

STEP 3: REPLACE COVER AND SCREWS. MAKE SURE SOLENOID IS PROPERLY POSITIONED IN COVER SLOT.

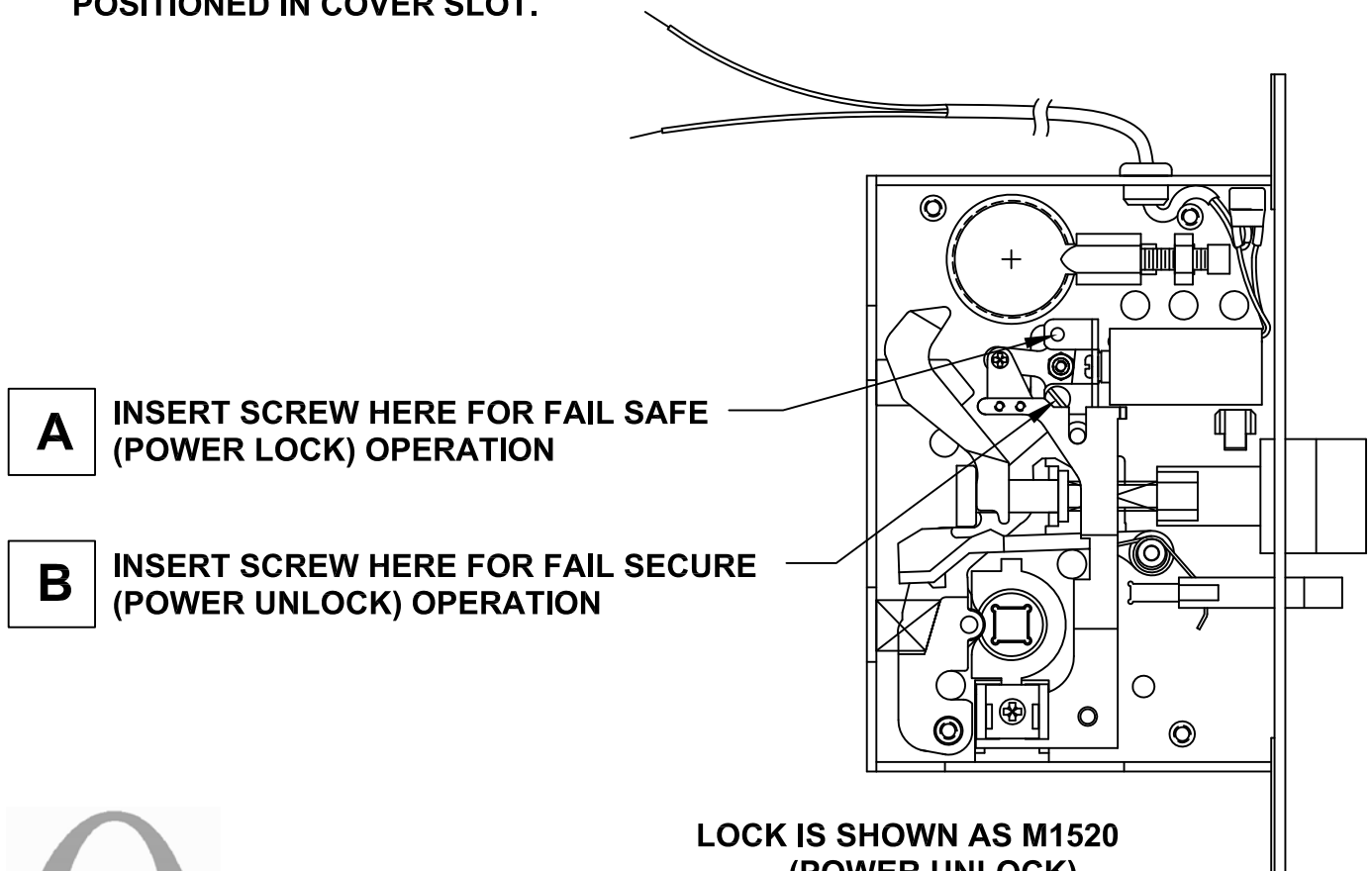

**A** INSERT SCREW HERE FOR FAIL SAFE (POWER LOCK) OPERATION

**B** INSERT SCREW HERE FOR FAIL SECURE (POWER UNLOCK) OPERATION

LOCK IS SHOWN AS M1520 (POWER UNLOCK)

